

CROSS OVER COUPLINGS AND ADAPTERS

Cross over couplings

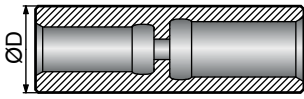

Thread	Length		Diameter (D)		Product No.	Product code	Weight approx. kg
	mm	inch	mm	inch			
R25-R32	160	6 ⁵ / ₁₆	44	1 ²³ / ₃₂	90515746	302-1044-03,10	1,2
R28-R32	160	6 ⁵ / ₁₆	44	1 ²³ / ₃₂	90515751	307-1044-03,10	1,2
R32-R38	170	6 ³ / ₄	55	2 ⁵ / ₃₂	90515748	303-1055-04,10	2,0
R32-T38	170	6 ³ / ₄	55	2 ⁵ / ₃₂	90515749	303-1055-35,10	2,0
R32-TC42	165	6 ¹ / ₂	57	2 ¹ / ₄	90003675	303-1057-71,10	2,2
T38-TC42	175	6 ¹ / ₈	57	2 ¹ / ₄	90516551	335-1057-71,10	2,0
R38-T38	180	7 ¹ / ₈	55	2 ⁵ / ₃₂	90515750	304-1055-35,10	1,8
T38-T45	180	7 ¹ / ₈	60	2 ³ / ₈	90515753	335-1061-36,10	2,4
T45-T51	225	8 ⁷ / ₈	72	2 ²⁷ / ₃₂	90515755	336-1072-37,10	4,5

Cross over adapters

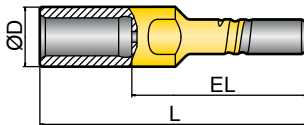

Thread		Length (L)		Effective length (EL)		Diameter (D)		Product No.	Product code	Weight approx. kg
Female	Male	mm	inch	mm	inch	mm	inch			
R25	R32	195	7 ¹¹ / ₁₆	120	4 ³ / ₄	45	1 ³ / ₄	90516019	302-2045-03,10	1,2
R32	R38	210	8 ¹ / ₄	135	5 ⁵ / ₁₆	45	1 ³ / ₄	90516020	303-2045-04,10	1,5
R32	T38	220	8 ⁵ / ₈	145	5 ¹¹ / ₁₆	45	1 ³ / ₄	90504217	303-2045-35,00	1,5
R38	R32	247	9 ³ / ₄	162	6 ³ / ₈	55	2 ⁵ / ₃₂	90516021	304-2055-03,10	2,2
R38	T38	250	9 ⁷ / ₈	165	6 ¹ / ₂	57	2 ¹ / ₄	90504088	304-2057-35,00	2,4
T38	R32	247	9 ³ / ₄	162	6 ³ / ₈	57	2 ¹ / ₄	90516022	335-2057-03,10	2,4
T38	R38	250	9 ⁷ / ₈	165	6 ¹ / ₂	57	2 ¹ / ₄	90516023	335-2057-04,10	3,4
T38	T45	260	10 ¹ / ₄	175	6 ⁷ / ₈	57	2 ¹ / ₄	90503941	335-2057-36,00	2,9
T45	T38	260	10 ¹ / ₄	175	6 ⁷ / ₈	63	2 ¹⁵ / ₃₂	90504244	336-2063-35,00	2,9
T45	T51	275	10 ⁷ / ₈	190	7 ¹ / ₂	63	2 ¹⁵ / ₃₂	90503942	336-2063-37,00	3,6
T51	T45	290	11 ³ / ₈	170	6 ³ / ₄	71	2 ²⁵ / ₃₂	90504330	337-2071-36,00	4,0







CROSS OVER COUPLINGS AND CROSS OVER ADAPTERS

Cross over couplings	140
Cross over adapters	140