

COPROD tube driver

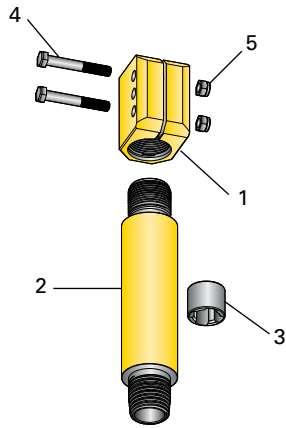

COPROD section for COPROD 127 and 140

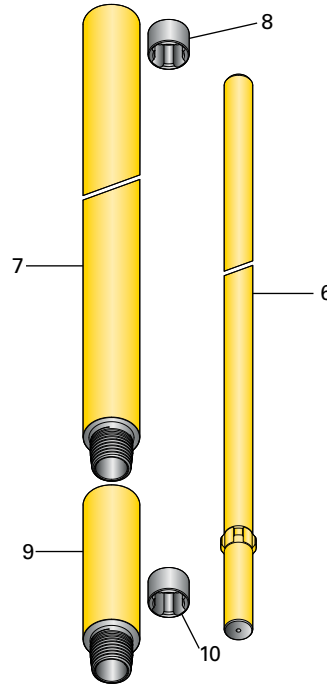

COPROD head

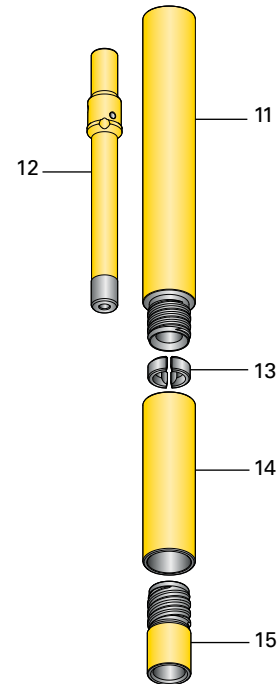

Part description	COP 4050CR					
	COPROD 127			COPROD 140		
	Product No.	Product code	Weight*	Product No.	Product code	Weight*
COPROD tube driver						
1 Coupling (for rotation chuck 3115 3215 02)	90003587	7970-2732-80	17,9	90003587	7970-2732-80	17,9
1 Coupling (for rotation chuck 3115 3215 01)	94800284	7970-0232-80	18,3	94800284	7970-0232-80	18,3
2 Tube adapter, L = 253 mm (10")	94800245	7970-2735-80	16,9	94800245	7970-2735-80	16,9
2 Tube adapter, L = 714 mm (2'4 1/8")	94800246	7970-2733-80	54,2	94800246	7970-2733-80	54,2
3 Rod guide	94800087	7970-0202-00	0,1	94800087	7970-0202-00	0,1
4 Bolt (2 pcs) M24 x 160**	-	-	-	-	-	-
5 Nut (2 pcs) M24**	-	-	-	-	-	-
COPROD section 6,1 m (20')	94800455	7970-2750-81	241	94800375	7970-4050-80	260
6 Rod 6100 mm (20')	94800295	7970-2751-00	94	94800295	7970-2751-00	94
7 Tube 6100 mm (20')	94800454	7970-2752-81	130	94800376	7970-4052-80	144
8 Rod guide	94800087	7970-0202-00	0,1	94800184	7970-2702-00	0,1
9 End piece	94800134	7970-2753-80	15,0	94800377	7970-4053-80	21,7
10 Rod guide	94800087	7970-0202-00	0,1	94800184	7970-2702-00	0,2
COPROD head	94800362	7970-2782-80	78	94800369	7970-4082-80	98
11 Bit tube	94800363	7970-2781-00	45	94800370	7970-4081-00	58
12 Bit rod	94800364	7970-2785-00	16,5	94800373	7970-4085-00	19,6
13 Stop ring	94800139	7970-2704-00	0,8	94800374	7970-4004-00	0,9
14 Bit chuck	94800331	7970-2773-00	11,2	94800371	7970-4083-00	14,4
15 Bit driver	94800141	7970-2774-00	5,0	94800372	7970-4084-00	5,5

* Weight approx. kg.

** Included in coupling.

COPROD tube driver

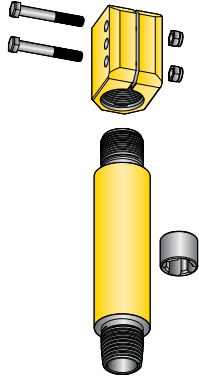

COPROD section for COPROD 76 and 89

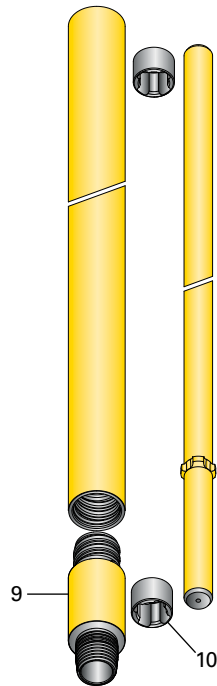

COPROD section for COPROD 102 and 127

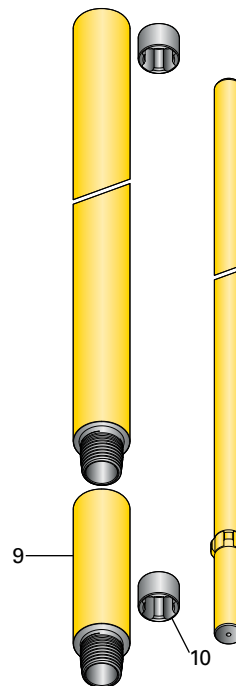

COPROD head

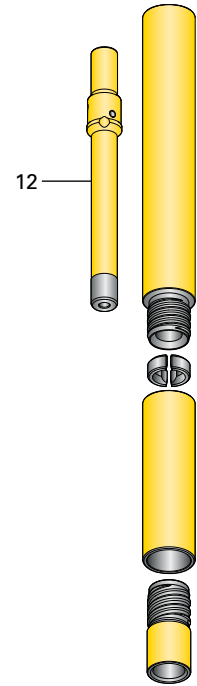

Part description	Product No.	Product code
Conversion kit for COPROD 76 to COPROD 89		
9 End piece	94800425	7970-7693-89-80
10 Rod guide	94800215	7970-8912-00
COPROD head	Use standard COPROD 89	
Conversion kit for COPROD 89 to COPROD 102		
9 End piece	94800423	7970-8993-02-80
10 Rod guide	94800121	7970-8902-00
COPROD head	Use standard COPROD 102 except for bitrod	
12 Bitrod	94800424	7970-0285-89-00
Conversion kit for COPROD 102 to COPROD 127		
9 End piece	94800426	7970-0253-27-80
10 Rod guide	94800087	7970-0202-00
COPROD head	Use standard COPROD 127	

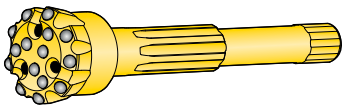

Flat front

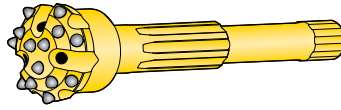

Convex front

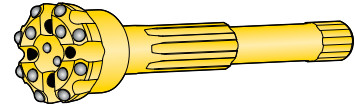

Drop center front

Drill bit	Diameter		Product No.	Product code	Buttons × button diameter (mm)			Gauge buttons angle°		Flushing holes No. × size mm	Weight approx. kg
	mm	inch			Gauge outer	Gauge inner	Centre	Outer	Inner		
COPROD 76 for	Flat front, HD, spherical buttons										
COP 1838CR	90	3 ⁹ / ₁₆	94800332	7976-1090-40,10-20	9×11	–	7×11	35°	–	3×8	5,8
COP 1850CR	95	3 ³ / ₄	94800333	7976-1095-40,10-20	9×12,7	–	7×11	35°	–	3×8	6,0
COP 2150CR	102	4	94800422	7976-1102-40,10-20	9×12,7	–	7×12,7	35°	–	3×10	6,3
COP 2550CR	105	4 ¹ / ₈	94800334	7976-1105-40,10-20	9×12,7	–	7×12,7	35°	–	3×10	6,4
	Convex front, full-ballistic buttons										
	90	3 ⁹ / ₁₆	94800335	7976-2090-66,10-20	7×12,7	4×12,7	2×12,7	40°	20°	2×10	5,6
	95	3 ³ / ₄	94800336	7976-2095-66,10-20	7×12,7	3×12,7	2×12,7	45°	30°	3×8	5,6
	105	4 ¹ / ₈	94800337	7976-2105-66,10-20	9×12,7	3×12,7	4×12,7	45°	30°	3×10	6,2
	Drop center front, spherical buttons										
	90	3 ⁹ / ₁₆	94800338	7976-3090-40,10-20	8×11	4×11	2×11	35°	–	4×8	5,7
	95	3 ³ / ₄	94800339	7976-3095-40,10-20	8×12,7	4×11	2×11	35°	–	4×8	5,8
	105	4 ¹ / ₈	94800340	7976-3105-40,10-20	8×12,7	4×12,7	2×11	35°	–	4×10	6,2
COPROD 89 for	Flat front, HD, spherical buttons										
COP 1838CR	105	4 ¹ / ₈	94800341	7989-1105-40,10-20	9×12,7	–	7×12,7	35°	–	3×13	9,1
COP 1850CR	110	4 ⁵ / ₁₆	94800342	7989-1110-40,10-20	9×14,5	–	6×14,5	35°	–	3×13	9,5
COP 2150CR	115	4 ¹ / ₂	94800343	7989-1115-40,10-20	9×14,5	–	6×14,5	35°	–	3×13	9,7
COP 2550CR	127	5	94800344	7989-1127-40,10-20	9×14,5	–	7×14,5	35°	–	3×13	10,6
COP 4050CR	Convex front, full-ballistic buttons										
	105	4 ¹ / ₈	94800345	7989-2105-66,10-20	9×12,7	3×12,7	4×12,7	45°	30°	3×13	8,8
	110	4 ⁵ / ₁₆	94800346	7989-2110-66,10-20	9×12,7	6×12,7	4×12,7	45°	30°	3×13	9,2
	115	4 ¹ / ₂	94800347	7989-2115-66,10-20	7×14,5	4×14,5	3×14,5	45°	30°	3×13	9,2
	127	5	94800348	7989-2127-66,10-20	9×14,5	6×14,5	4×14,5	45°	30°	3×13	10,1
	Drop center front, spherical buttons										
	105	4 ¹ / ₈	94800349	7989-3105-40,10-20	8×12,7	4×12,7	2×11	35°	–	4×13	8,9
	115	4 ¹ / ₂	94800351	7989-3115-40,10-20	8×14,5	4×14,5	2×11	35°	–	4×13	9,5
	127	5	94800352	7989-3127-40,10-20	8×14,5	4×14,5	4×11	35°	–	4×13	10,3
	Drop center front, full-ballistic buttons										
	105	4 ¹ / ₈	94800443	7989-3105-66,10-20	8×12,7	4×12,7	2×11	40°	–	4×13	8,8

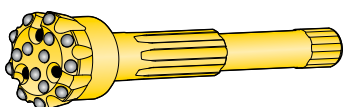

Flat front

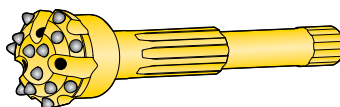

Convex front

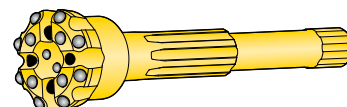

Drop center front

Drill bit	Diameter		Product No.	Product code	Buttons × button diameter (mm)			Gauge buttons angle°		Flushing holes No. × size mm	Weight approx. kg
	mm	inch			Gauge outer	Gauge inner	Centre	Outer	Inner		
COPROD 102 for COP 4050CR	Flat front, HD, spherical buttons										
	115	4½	94800353	7902-1115-40,10-20	9×14,5	–	6×14,5	35°	–	3×13	12,6
	127	5	94800354	7902-1127-40,10-20	9×14,5	–	7×14,5	35°	–	3×13	13,2
	140	5½	94800355	7902-1140-40,10-20	9×16	–	9×16	35°	–	3×13	14,5
	Convex front, full-ballistic buttons										
	115	4½	94800356	7902-2115-66,10-20	7×14,5	4×14,5	3×14,5	45°	30°	3×13	12,2
	127	5	94800357	7902-2127-66,10-20	9×14,5	6×14,5	4×14,5	45°	30°	3×13	12,8
	140	5½	94800358	7902-2140-66,10-20	9×14,5	6×14,5	5×14,5	45°	30°	3×13	13,8
	Drop center front, spherical buttons										
	115	4½	94800359	7902-3115-40,10-20	8×14,5	4×14,5	2×11	35°	–	4×13	12,4
	127	5	94800360	7902-3127-40,10-20	8×14,5	4×14,5	4×11	35°	–	4×13	13,0
	140	5½	94800361	7902-3140-40,10-20	9×16	6×16	4×12,7	35°	–	3×13	14,5
COPROD 127 for COP 4050CR	Flat front, HD, spherical buttons										
	140	5½	94800383	7927-1140-40,10-20	9×16	–	9×16	35°	–	3×15	22,2
	152	6	94800417	7927-1152-40,10-20	9×16	–	9×16	35°	–	3×16	22,9
	165	6½	94800384	7927-1165-40,10-20	10×16	–	10×16	35°	–	3×15	23,9
	Convex front, full-ballistic buttons										
	152	6	94800418	7927-2152-66,10-20	9×16	6×16	4×16	45°	30°	3×16	22,3
	165	6½	94800385	7927-2165-66,10-20	9×16	6×16	6×16	45°	30°	3×15	23,1
	Drop center front, spherical buttons										
	165	6½	94800378	7927-3165-40,10-20	10×16	6×16	5×16	35°	–	2×18	23,8
	Drop center front, full-ballistic buttons										
140	5½	94800368	7927-3140-66,10-20	9×16	6×16	4×12,7	35°	–	3×16	20,2	
COPROD 140 for COP 4050CR	Convex front, full-ballistic buttons										
	165	6½	94800379	7940-2165-66,08-20	9×16	6×16	7×16	45°	25°	3×16	30,1
	180	7⅞	94800381	7940-2180-66,08-20	9×16	6×16	7×16	45°	25°	3×16	31,2





COPROD

COPROD 76 and 89 for COP 2550CR	132
COPROD 89 and 102 for COP 3060CR and COP 4050CR	133
COPROD 127 and 140 for COP 4050CR	134
Conversion kit	135
Drill bits	136

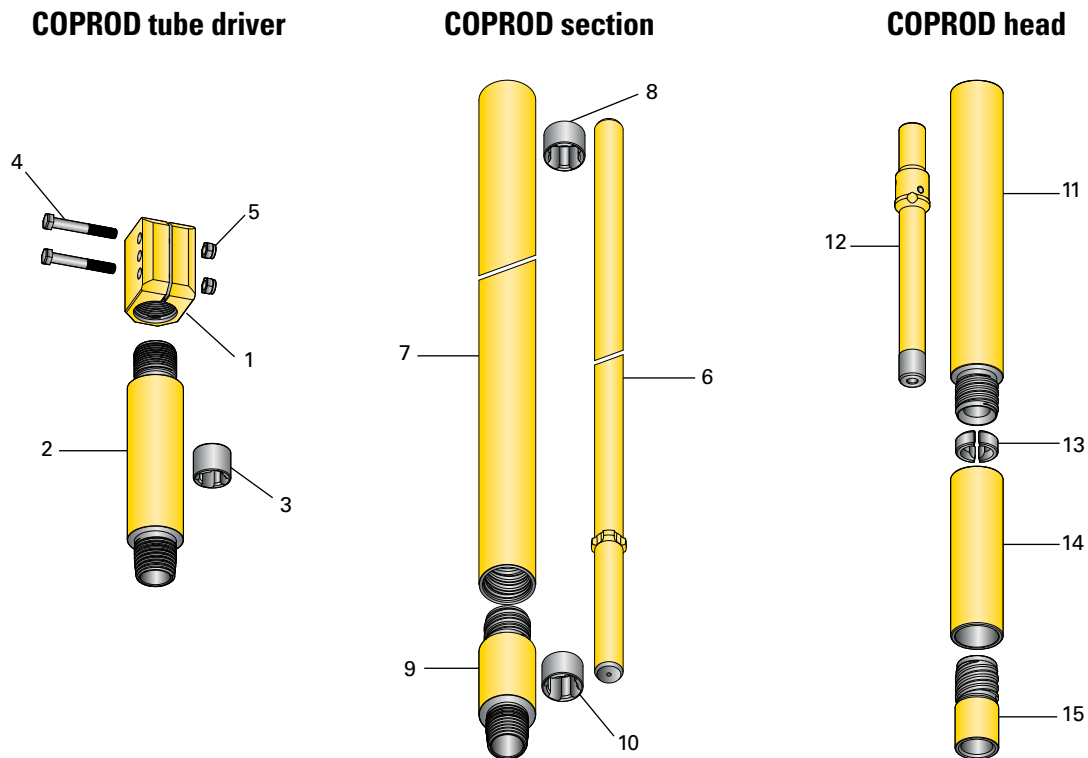

Part description	COP 2550CR					
	COPROD 76			COPROD 89		
	Product No.	Product code	Weight*	Product No.	Product code	Weight*
COPROD tube driver						
1 Coupling	94800299	7970-8928-80	6,3	94800299	7970-8928-80	6,3
2 Tube adapter, L = 350 mm (1'1 ³ / ₄ "	94800220	7970-7635-80	7,3	94800239	7970-8946-80	11,1
2 Tube adapter, L = 807 mm (2'7 ³ / ₄ "	-	-	-	94800240	7970-8943-80	27,1
3 Rod guide	94800215	7970-8912-00	0,1	94800215	7970-8912-00	0,1
4 Bolt (2 pcs) M16 x 110 (M16 x 150 for TED)**	-	-	-	-	-	-
5 Nut (2 pcs) M16**	-	-	-	-	-	-
COPROD section 3,66 m (12')	94800445	7970-7690-81	100	94800447	7970-8990-81	118
6 Rod 3660 mm (12')	94800314	7970-7691-00	44	94800327	7970-8991-00	46
7 Tube 3660 mm (12')	94800444	7970-7692-81	52	94800446	7970-8992-81	66
8 Rod guide	94800215	7970-8912-00	0,1	94800121	7970-8902-00	0,1
9 End piece	94800316	7970-7693-80	4,1	94800329	7970-8993-80	6,1
10 Rod guide	94800215	7970-8912-00	0,1	94800121	7970-8902-00	0,1
COPROD head	94800317	7970-7682-80	22	94800310	7970-8982-80	32
11 Bit tube	94800318	7970-7681-00	12,3	94800311	7970-8981-00	18,2
12 Bit rod	94800365	7970-7685-00	4,4	94800366	7970-8985-00	5,6
13 Stop ring	94800235	7970-7604-00	0,2	94800128	7970-8904-00	0,4
14 Bit chuck	94800320	7970-7683-00	3,8	94800298	7970-8983-00	5,8
15 Bit driver	94800227	7970-7674-00	1,8	94800272	7970-8984-00	2,8

* Weight approx. kg.

** Included in coupling.

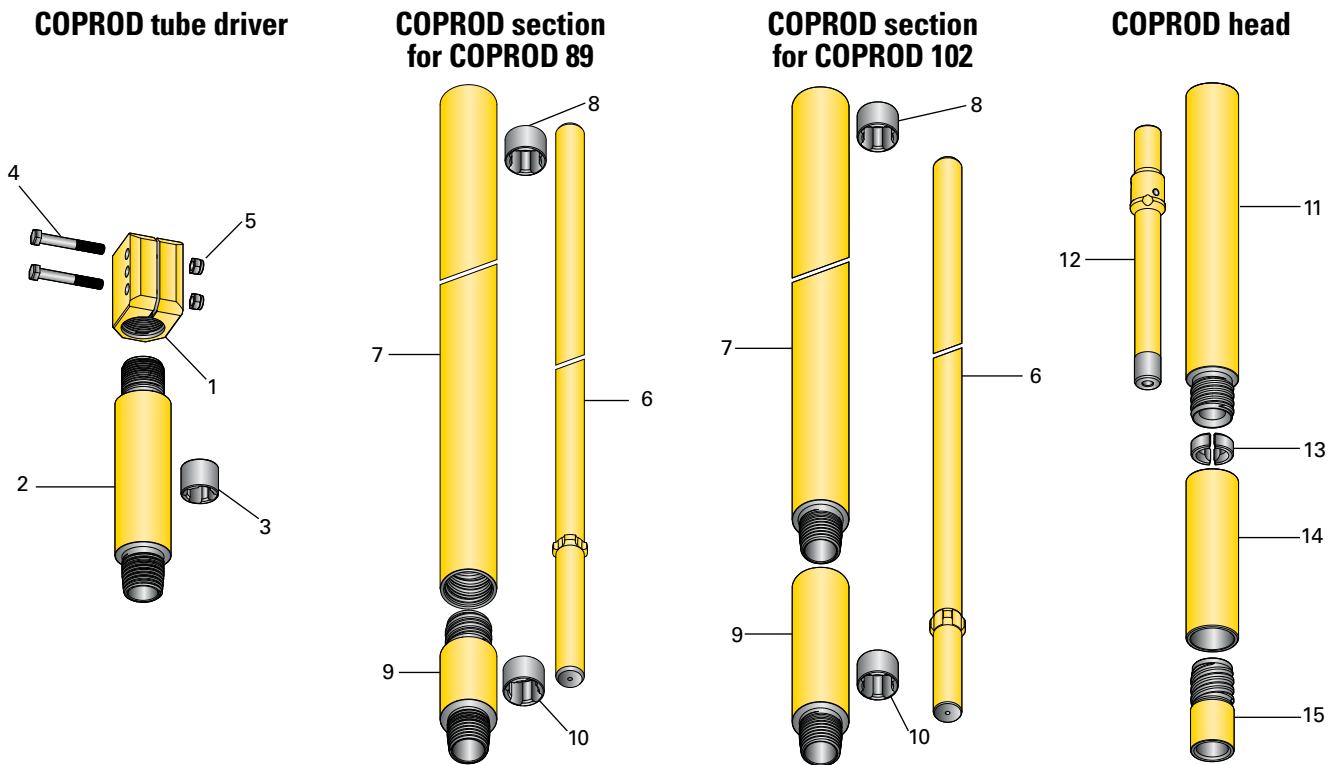

Part description	COP 3060CR and COP 4050CR					
	COPROD 89			COPROD 102		
	Product No.	Product code	Weight*	Product No.	Product code	Weight*
COPROD tube driver						
1 Coupling (standard)	90029136	7970-0226-80	18,8	90029136	7970-0226-80	18,8
1 Coupling (for rotation chuck 3115 3215 02)	90003587	7970-2732-80	17,9	90003587	7970-2732-80	17,9
1 Coupling (for rotation chuck 3115 3215 01)	94800284	7970-0232-80	18,3	94800284	7970-0232-80	18,3
2 Tube adapter, L = 500 mm (1'7 ⁵ / ₈ ") - CR89 L = 512 mm (1'8 ¹ / ₄ ") - CR102	90029133	7970-8927-80	13,8	90029132	7970-0227-80	17,7
2 Tube adapter, L = 253 mm (10")	94800241	7970-8935-80	7,8	94800243	7970-0235-80	9,5
2 Tube adapter, L = 714 mm (2'4 ¹ / ₈ ")	94800242	7970-8933-80	21,6	94800244	7970-0233-80	30,4
3 Rod guide	94800121	7970-8902-00	0,1	94800087	7970-0202-00	0,1
4 Bolt (2 pcs) M24 x 160**	-	-	-	-	-	-
5 Nut (2 pcs) M24**	-	-	-	-	-	-
COPROD section 3,66 m (12')	94800447	7970-8990-81	118	94800451	7970-0240-81	128
6 Rod 3660 mm (12')	94800327	7970-8991-00	46	94800303	7970-0241-00	56
7 Tube 3660 mm (12')	94800446	7970-8992-81	66	94800450	7970-0242-81	60
8 Rod guide	94800121	7970-8902-00	0,1	94800087	7970-0202-00	0,1
9 End piece	94800329	7970-8993-80	6,1	94800086	7970-0253-80	11,7
10 Rod guide	94800121	7970-8902-00	0,1	94800087	7970-0202-00	0,1
COPROD section 6,1 m (20')	94800449	7970-8955-81	190	94800453	7970-0250-81	199
6 Rod 6100 mm (20')	94800387	7970-8956-00	76	94800084	7970-0251-00	94
7 Tube 6100 mm (20')	94800448	7970-8957-81	108	94800452	7970-0252-81	93
8 Rod guide	94800121	7970-8902-00	0,1	94800087	7970-0202-00	0,1
9 End piece	94800329	7970-8993-80	6,1	94800086	7970-0253-80	11,7
10 Rod guide	94800121	7970-8902-00	0,1	94800087	7970-0202-00	0,1
COPROD head	94800310	7970-8982-80	32	94800324	7970-0282-80	47
11 Bit tube	94800311	7970-8981-00	18,2	94800323	7970-0281-00	26,1
12 Bit rod	94800366	7970-8985-00	5,6	94800367	7970-0285-00	10,4
13 Stop ring	94800128	7970-8904-00	0,4	94800096	7970-0204-00	0,5
14 Bit chuck	94800298	7970-8983-00	5,8	94800325	7970-0273-00	7,5
15 Bit driver	94800272	7970-8984-00	2,8	94800082	7970-0274-00	2,9

* Weight approx. kg.

** Included in coupling.