

Recovery sleeves for TDS tubes

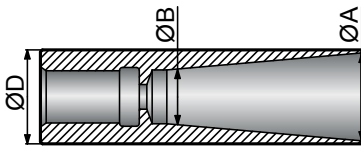

Thread	ØD		Major inner diam. (ØA)		Minor inner diam. (ØB)		Product No.	Product code	Weight approx. kg
	mm	inch	mm	inch	mm	inch			
For TDS tubes									
ST58	90	3 ⁹ / ₁₆	80	3 ⁵ / ₃₂	57	2 ¹ / ₄	94000012	9269,49	4,9
ST68	102	4	92	3 ⁵ / ₈	70	2 ³ / ₄	94502423	9267,49	6,2

Rod wrenches

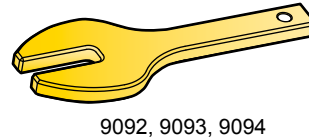
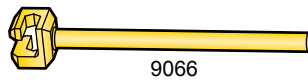
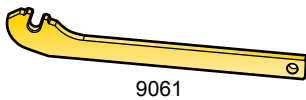

Rod dimension	Product No.	Product code	Weight approx. kg
22 mm (7/8") hex.	90000359	9061,49	4,5
22 mm (7/8") hex., Integrals	90000879	9066,49	1,8
25 mm (1") hex., Ø 32 mm (1 1/4")	90002028	9092,49	3,0
32 mm (1 1/4") hex., Ø 38 mm (1 1/2")	90002029	9093,49	3,6
38 mm (1 1/2") hex., Ø 45 mm (1 3/4")	90002030	9094,49	3,7

Shank seals

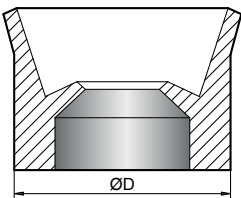

Tube diameter		Outer diameter (D)		Product No.	Product code
mm	inch	mm	inch		
5	3/16	10	13/32	90002182	9232
6,5	1/4	9,3	23/64	90002047	9159-06
8	5/16	14	9/16	90000378	9150-08
10	13/32	17	21/32	90002571	9151-10
14,3	9/16	22	7/8	90000466	9156-14
19	3/4	27	1 1/16	90002008	9158-19
23	29/32	34	1 11/32	90504645	9158-23

Thread grease



Acinol grease	Product No.	Product code
4,5 kg (10 lbs) package	90000382	9201,49
18 kg (40 lbs) package	90002915	9210,49
50 kg (110 lbs) package	90503915	9200,49

Chuck bushing gauges



Bushing		Product No.	Product code
mm	inch		
19	3/4	90002667	9131
22	7/8	90002668	9132
25	1	90002669	9133

Plastic blast hole plugs

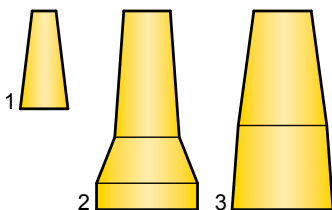

Illustr. No.	Hole diameter		Product No.	Product code
	mm	inch		
1	30–40	1 ³ / ₁₆ –1 ⁹ / ₁₆	90000328	9202
	40–50	1 ⁹ / ₁₆ –1 ³¹ / ₃₂	90000329	9203
2	50–75	1 ³¹ / ₃₂ –2 ¹⁵ / ₁₆	90000397	9204
	51	2	90003211	9207
	64	2 ¹ / ₂	90002315	9205
3	76	3	90503386	9208
	75–120	2 ¹⁵ / ₁₆ –4 ³ / ₄	90003083	9206

Knock-off tools

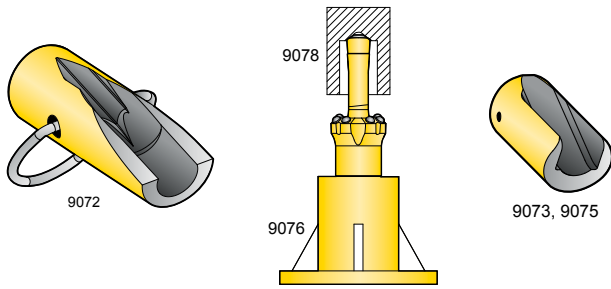

Rod diam. hex.		Product No.	Product code	Weight approx. kg
mm	inch			
Pilot rod				
–	–	90000318	9072,49	4,6
Pilot adapter				
–	–	90000928	9076,49	6,6
–	–	90000930	9078,49	2,1
Tapered rod				
22	7/8	90504619	9073,49	1,1
25	1	90504620	9075,49	1,1

Shim

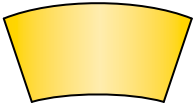

Description	Product No.	Product code
Shim for 7° taper and 12° taper	90503908	9162,49





AUXILIARY TOOLS

Recovery pikes	144
Recovery sleeves	144
Rod wrenches	145
Shank seals	145
Thread grease	146
Chuck bushing gauges	146
Plastic blast hole plugs	146
Knock-off tools.....	147
Shim.....	147

Recovery pikes

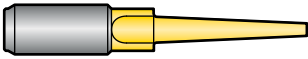

Thread		Product No.	Product code		Weight approx. kg
mm	inch		Rope thread	T thread	
32	1¼	90000331	9002,49		0,5
38	1½	90001971		9250,49	1,0
45	1¾	90002079		9253,49	1,3
51	2	90002872		9265,49	2,3

Recovery pikes for TDS tubes

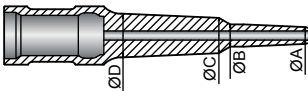

API Reg. Pin	A		B		C		D		Product No.	Product code	Weight approx. kg
	mm	inch	mm	inch	mm	inch	mm	inch			
For TDS tubes											
ST58	22	7/8	29	1 5/32	50	1 31/32	59	2 5/16	94000061	9268,49	5,5
ST68	18	23/32	43	1 11/16	60	2 3/8	71	2 25/32	90510783	9277,49	7,7

Recovery sleeves

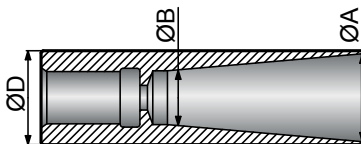

Thread	ØD		Major inner diam. (ØA)		Minor inner diam. (ØB)		Product No.	Product code		Weight approx. kg
	mm	inch	mm	inch	mm	inch		Rope thread	T thread	
For extension rods										
R32	49	1 15/16	47,2	1 27/32	23	29/32	90510880	9041,49		1,7
R38	60	2 3/8	57,2	2 1/4	30	1 3/16	90510881	9042,49		3,1
T38	61	2 13/32	58,2	2 9/32	30	1 3/16	90510882		9043,49	4,1
T45	71	2 25/32	68	2 11/16	36	1 13/32	90510883		9044,49	5,8
T51	82	3 7/32	78,2	3 1/16	41	1 5/8	90510884		9045,49	8,3
For couplings										
R32	49	1 15/16	47,2	1 27/32	23	29/32	90510880	9041,49		1,7
T45	71	2 25/32	68	2 11/16	36	1 13/32	90510883		9044,49	5,8
T51	82	3 7/32	78,2	3 1/16	41	1 5/8	90510884		9045,49	8,3
For Speedrods										
T45	71	2 25/32	68	2 11/16	36	1 13/32	90510883		9044,49	5,8
T51	82	3 7/32	78,2	3 1/16	41	1 5/8	90510884		9045,49	8,3